



## ECOFIN PU LIQUID MEMBRANE

Ecofin PU waterproofing membranes have a long and successful history and are produced under strict quality control standards. Ecofin PU membranes have been specially developed to achieve a fast, sustainable, durable and eco-friendly waterproofing solution.



[www.ecofinwaterproofing.com](http://www.ecofinwaterproofing.com)

[info@ecofinwaterproofing.com](mailto:info@ecofinwaterproofing.com)

## OSB ROOF

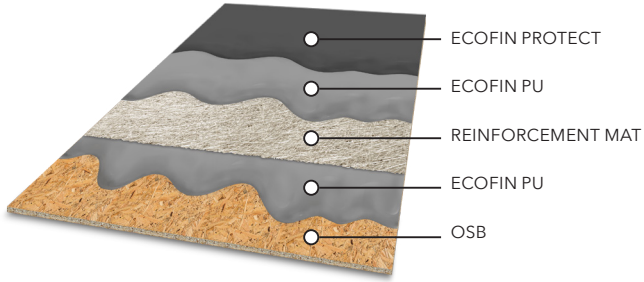

## WARM ROOF

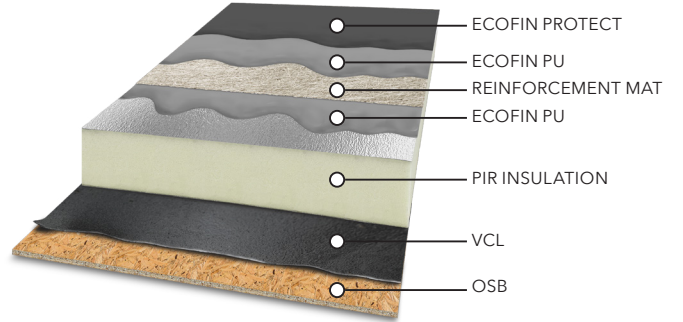

## OVERLAY

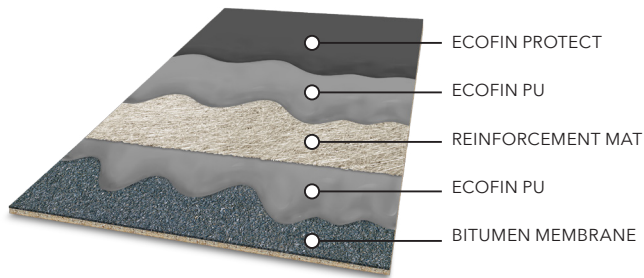

## CORRUGATED SHEET

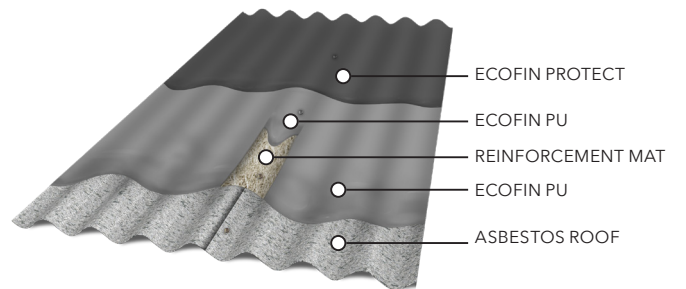

## CONCRETE ROOF

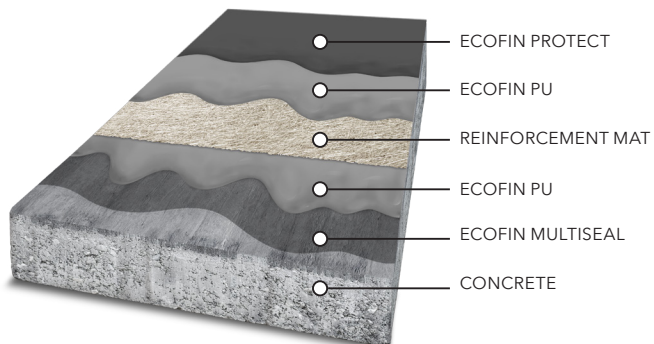

## GREEN ROOF

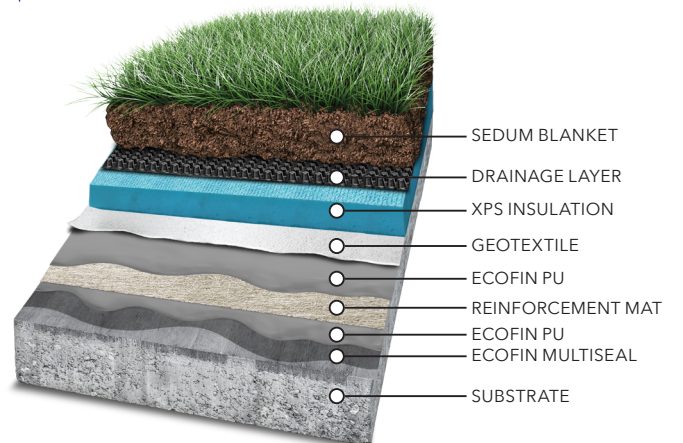

# BENEFITS

 <p>Provides long term UV resistance.</p>	 <p><b>FIRE RESISTANCE</b> Ecofin membranes hold Broof T4 fire classification.</p>	 <p><b>ALL YEAR</b> Ecofin can be installed all year.</p>	 <p><b>NHBC</b> Approved for NHBC projects.</p>		
 <p><b>SUSTAINABILITY</b> Certified Lifespan in excess of 25 years.</p>	 <p><b>GUARANTEES</b> Available for 15, 20 and 25 years.</p>				
 <p><b>EXCELLENT ADHESION</b> Excellent bonding to most roofing substrates.</p>	 <p><b>ENVIRONMENTALLY FRIENDLY</b> Ecofin respects the environment during production and installation.</p>				
 <p><b>SAFE APPLICATION</b> No naked flames required.</p>	 <p><b>TRAFFICABLE</b> Allows pedestrian traffic once cured.</p>				
 <p><b>AESTHETICS</b> Ecofin provides a modern and aesthetically pleasing roof finish.</p>	 <p><b>TECHNICAL SUPPORT</b> Technical reports and CAD drawings available.</p>			 <p><b>CERTIFICATIONS</b> Certified to the highest standards and BBA approval.</p>	 <p><b>CERTIFICATIONS</b> Certified for green roofs</p>

## PRODUCT RANGE

PRODUCT	DESCRIPTION	KG/LTS	COVERAGE	DRYING TIME
<b>ECOFIN PU</b>	Liquid membrane	15kg drums 60 drums per pallet	8-10 sqm	2-6 hours <i>*depending on temperature and humidity. Fully cured in 24hrs</i>
<b>ECOFIN MULTISEAL</b>	Clear membrane as sealing coat or primer	5Lts	10-30sqm <i>*depending on application</i>	2 - 4 hours
<b>ECOFIN PROTECT</b>	UV resistant topcoat	5Lts	20-30sqm	1 - 2 hours
<b>ECOFIN MATT</b>	Reinforcing matt	----	20x1 sqm 60x1 sqm	----

STORAGE 5- 25C - protect from frost and direct sunlight

Also available other sizes

## APPLICATION GUIDE

- Check the substrate is clean and in good condition.
- Application temperature must be between 5 - 35C.
- All trims must be fixed prior to Ecofin application.
- Use a PU sealant to seal any cracks or gaps.
- Open the drum and stir before applying Ecofin.
- If product is left to stand on site, stir again before application.
- Apply Ecofin liquid as described below, first to details and perimeters and then to the flat area.
- Apply Ecofin liquid wet-on-wet by applying a generous coat of liquid first, then dry rolling the matting into the liquid and finally applying more liquid on top to achieve the required thickness. Ensure the matting is fully encapsulated without pinholes or tenting.
- At this stage the roof is watertight and will resist rain.
- Typical coverage is 8-10 sqm per drum although this may vary depending on substrate.
- After applying the waterproofing layer check for pinholes or any dry areas that may require more liquid.
- Once the Ecofin membrane is dry, apply a layer of Ecofin Protect topcoat within 48 hours.
- Check the full application sheet for specific substrates and systems.

## USE OF MULTISEAL PRIMER

- |  |  |  |
|--|--|--|
| <input checked="" type="checkbox"/> CONCRETE         | <input checked="" type="checkbox"/> TPO SINGLE PLY | <input checked="" type="checkbox"/> OSB/PLYWOOD    |
| <input checked="" type="checkbox"/> ASBESTOS         | <input checked="" type="checkbox"/> EPDM MEMBRANE  | <input checked="" type="checkbox"/> METAL          |
| <input checked="" type="checkbox"/> BITUMEN MEMBRANE | <input checked="" type="checkbox"/> ASPHALT        | <input checked="" type="checkbox"/> PVC SINGLE PLY |